

# RSIC-1 ACOUSTIC ASSEMBLY



Toll Free 866-774-2100 • Telephone 503-649-7700

## WALL ASSEMBLY

### DIRECT FIX TO WOOD OR STEEL FRAMING



#### Party Wall Assembly STC 66

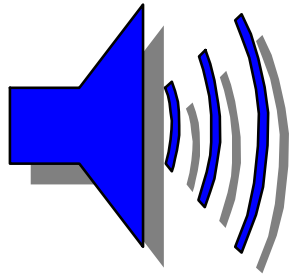

# STC 66

#### CONSTRUCTION

- \* 1 layer 5/8" Gypsum
- \* 2 x 4 stud
- \* RSIC-1 clips at 48" o.c.
- \* 7/8" x 25 ga. furring Channel @ 24" o.c.
- \* 1 Layer 5/8" Gypsum
- \* 1" air gap
- \* 1 Layer 5/8" Gypsum
- \* RSIC-1 clips at 48" o.c.
- \* 7/8" x 25 ga. furring Channel @ 24" o.c.
- \* 2 x 4 stud
- \* 1 layer 5/8" Gypsum

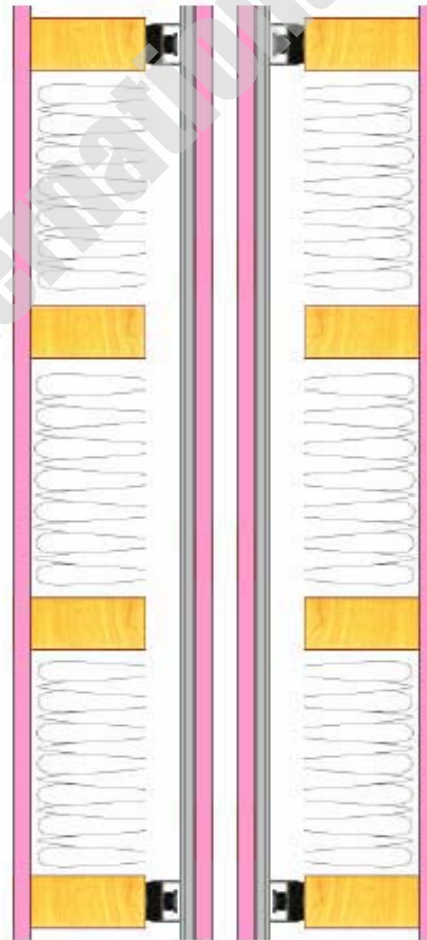

**SOUND  
TRANSMISSION  
CLASS**

**STC 66**