

PAC INTERNATIONAL, INC. FLOOR CEILING ASSEMBLY DROPPED CEILING UNDER OPEN WEB TRUSS JOIST

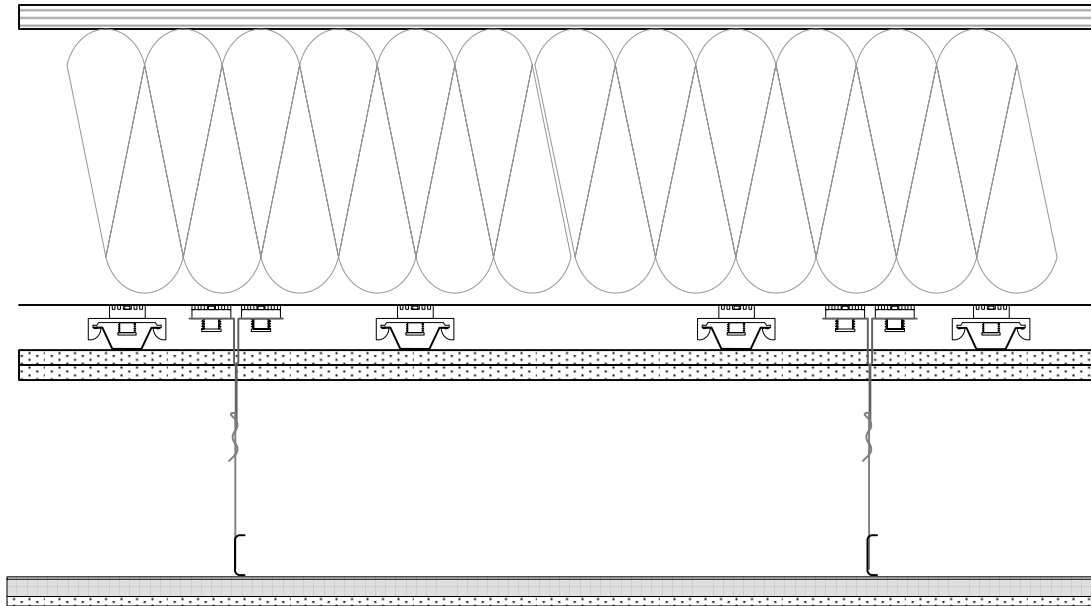

- TOPPING (GYPCRETE, TILE, HARDWOOD, OR CARPET)
- $\frac{3}{4}$ " PLYWOOD SHEATHING
GLUES & SCREWED
- OPEN WEB TRUSS
- BLOWN IN INSULATION (FULL DEPTH OF CAVITY)
- RSIC-1 CLIPS AT 16" X 48" O.C.
- $\frac{7}{8}$ " DRYWALL FURRING CHANNEL AT 16" OC
- 2 LAYERS $\frac{5}{8}$ " GYPSUM BOARD
- RSIC-DC04X2 SOUND ISOLATION CLIPS @ 48" X 48" O.C. (or as needed to support the gypsum board for the soffit)
- $1\frac{1}{2}$ " 16GA. COLD ROLLED CHANNEL
- $\frac{7}{8}$ " DRYWALL FURRING CHANNEL TIED TO THE BOTTOM OF THE $1\frac{1}{2}$ " 16GA. COLD ROLLED CHANNEL
- 1 LAYER OF $\frac{5}{8}$ " GYPSUM BOARD.

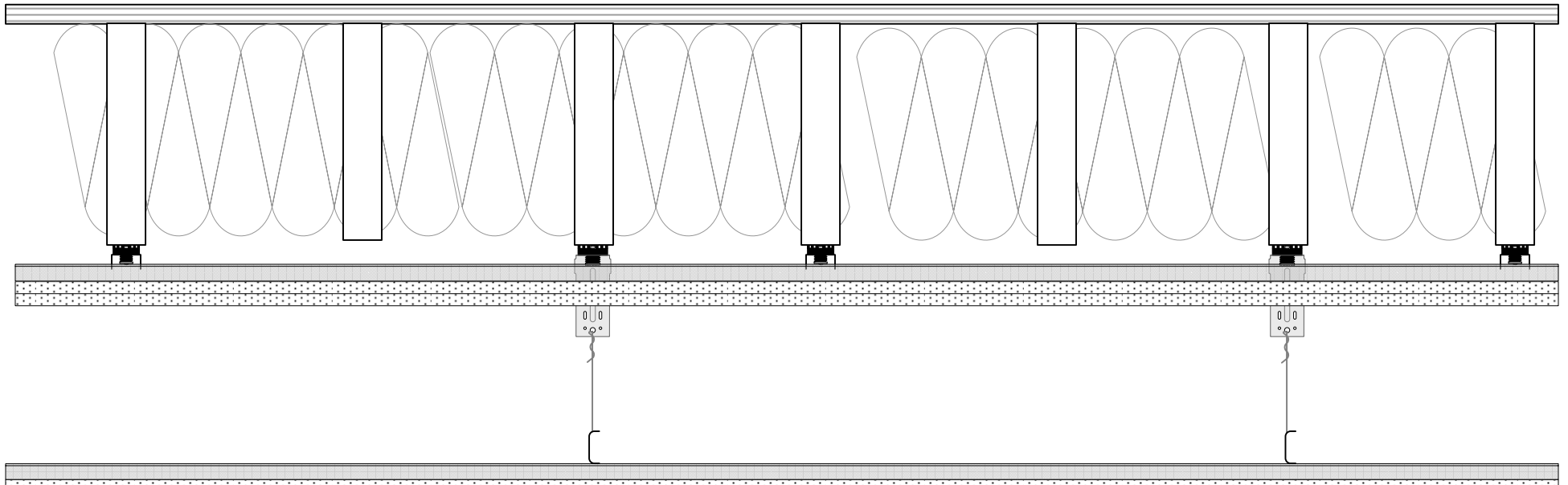

WEBSITE: WWW.PAC-INTL.COM TEL: (866) 774-2100 FAX: (866) 649-2710 PO BOX 5369 ALOHA, OR 97007

© PAC International, Inc. — All Rights Reserved.