

RSIC ACOUSTIC ASSEMBLY

FLOOR CEILING ASSEMBLY

DIRECT FIX TO STEEL "C" JOIST



Toll Free 866-774-2100 • Telephone 503-649-7700

FCST ESCH-CENTENN FSTC 60 FIIC 59

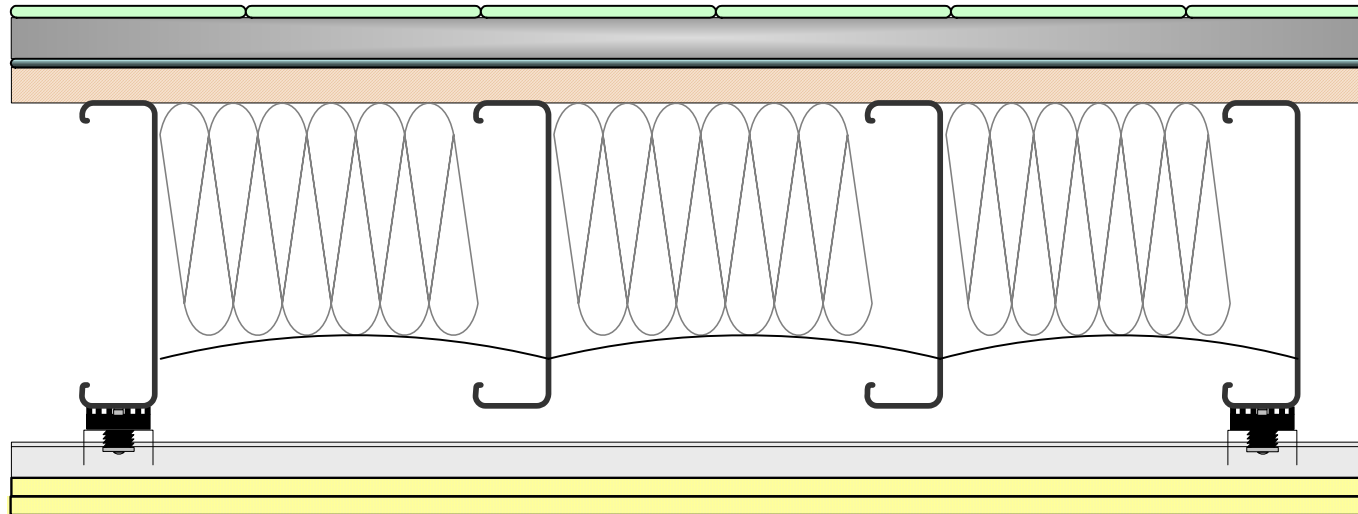

CONSTRUCTION

- STONE FLOORING
- 1-1/4" LT WT GYPSUM CONCRETE
- 1/4" ACOUSTICAL MAT
- 3/4" T&G PLYWOOD SUBFLOOR
- CEMCO 12" X 16 GA STEEL "C" SECTION JOIST @ 24" OC
- R-19 FIBERGLASS BATT INSULATION (NOM 6")
- RSIC-1 INSTALLED @ 48" OC
- 7/8" DRYWALL FURRING CHANNEL @ 24" OC
- 2 LAYERS 5/8" PABCO FIRE CODE "C" GYPSUM BOARD



Fire Resistance Ratings

Designs:
L573



FSTC 60

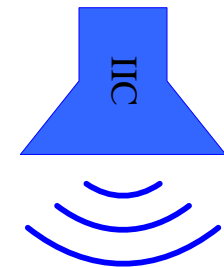

FIIC 59

FIELD TESTED