

RSIC-1 Acoustic Assembly

FLOOR / CEILING SYSTEMS

DIRECT FIX CEILING UNDER STEEL JOIST



FCS 101-CJ Steel Joist

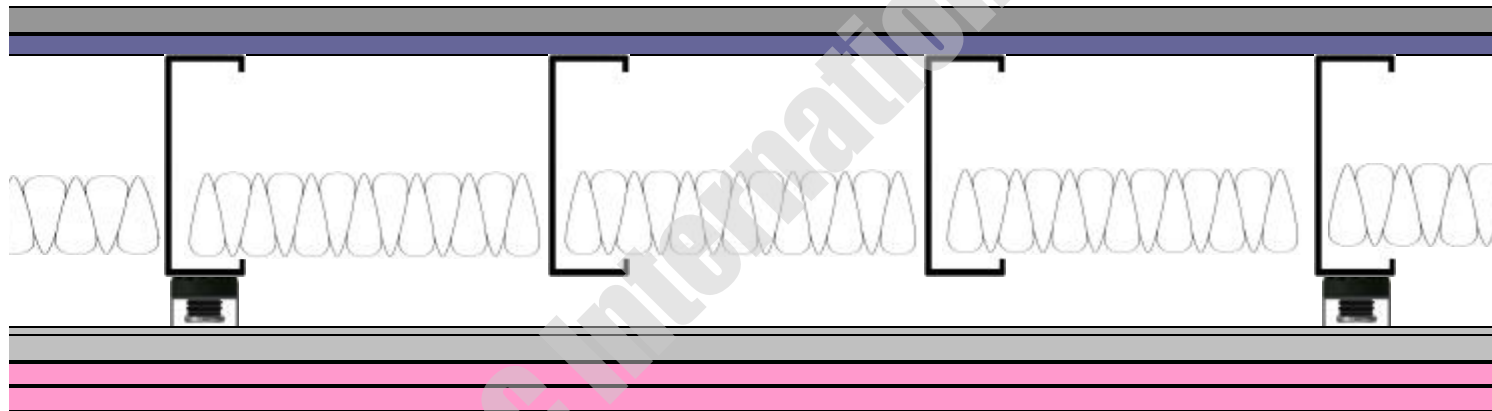

Construction

- * 3/4" thick light weight 'Gypsum Cement' top coat..
- * 5/8" tongue and groove 'USG Fiber Rock' substrate.
- * 8 / 10" steel joists at 16"oc.
- * 3 1/2" fiberglass insulation between joists.
- * RSIC-1 acoustic assembly screwed to joists at 4' 0"oc.
- * 7/8" furring channels at 2' 0"oc.
- * 2 x 5/8" fire rated gypsum wallboard sheets taped and set.



SOUND TRANSMISSION CLASS	IMPACT ISOLATION CLASS
STC 57	IIC 51