

RSIC-1 Acoustic Assembly

FLOOR / CEILING SYSTEMS

DIRECT FIX CEILING UNDER TIMBER FLOOR



Toll Free 866-774-2100 • Telephone 503-649-7700

FCS **RAL-TL 02-17 / IN 02-5**

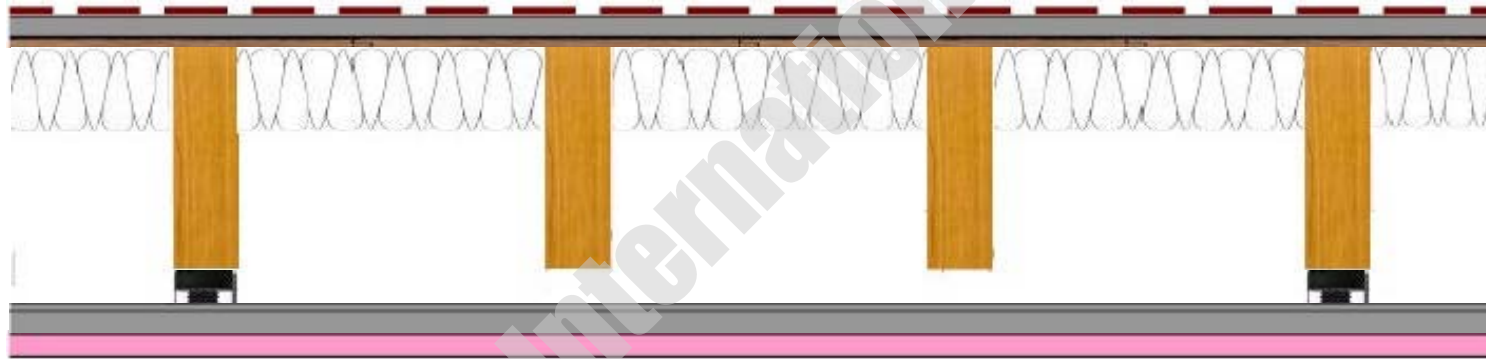

Construction

- * Ceramic Tile
- * 1" Lt Wt Gypsum Concrete
- * Dampproofing Membrane
- * 3/4" T & G Plywood
- * 3-1/2" R-11 Insulation
- * 18" Parallel Chord Truss
- * RSIC-1 Installed 48" oc.
- * 7/8" Furring Channel 24" oc.
- * 1 Layer 5/8" Gypsum Drywall
- * **Riverbank Acoustical Lab RAL-TL 02-17 / IN 02-5**



	
SOUND TRANSMISSION CLASS	Fire Resistance Ratings ANS/UL 263 Design No. L562
STC 60	IMPACT ISOLATION CLASS
STC 60	IIC 48

[CLICK HERE for Full Test Report](#)