

RSIC-1 ACOUSTIC ASSEMBLY

FLOOR/CEILING ASSEMBLY

DIRECT FIX TO ENGINEERED JOIST



Telephone: (503) 649-7700

Fax: (503) 649-2710

www.pac-intl.com

FCS1 SMWNV FIIC63-FSTC57

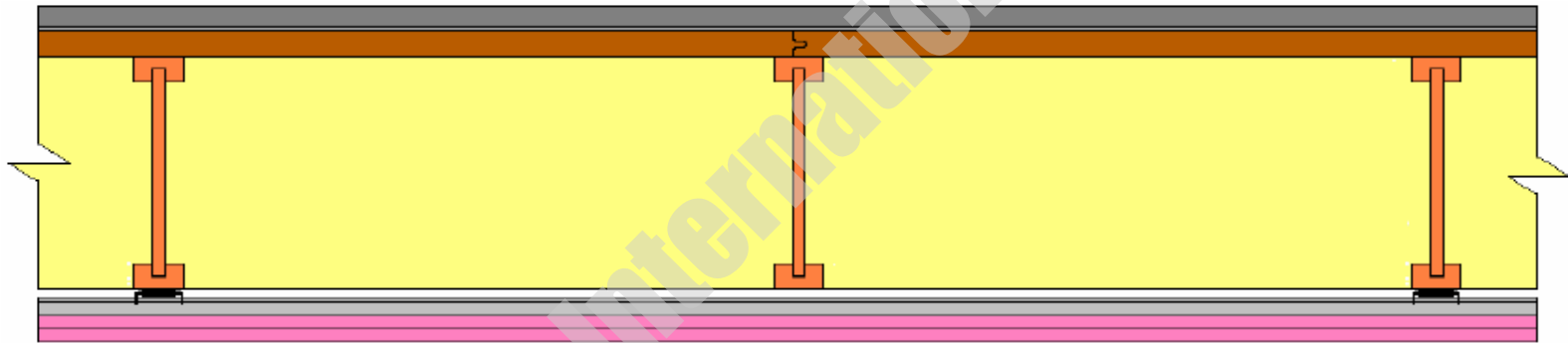

CONSTRUCTION

- * Ceramic Tile
- * 1-1/4" thick lightweight concrete floorslab
- * 1/4" thick resilient floor membrane
- * 1-1/8" T&G plywood deck
- * 22" deep I-beam
- * Cellulose insulation 22" blown in
- * RSIC-1 installed 48" oc.
- * 7/8" furring channel 24" oc.
- * 2 Layers 5/8" Gypsum Drywall



**FIELD SOUND
TRANSMISSION
CLASS**

FSTC 57



**Fire resistance ratings
ANS/UL
Design L518 (generic version)**

**FIELD IMPACT
ISOLATION
CLASS**

FIIC 63

[CLICK HERE for Full Test Report](#)