

# RSIC-1 Acoustic Assembly



Toll Free 866-774-2100 • Telephone 503-649-7700

## FLOOR / CEILING SYSTEMS

### DIRECT FIX CEILING UNDER TIMBER FLOOR



#### FCS 6 CARPET

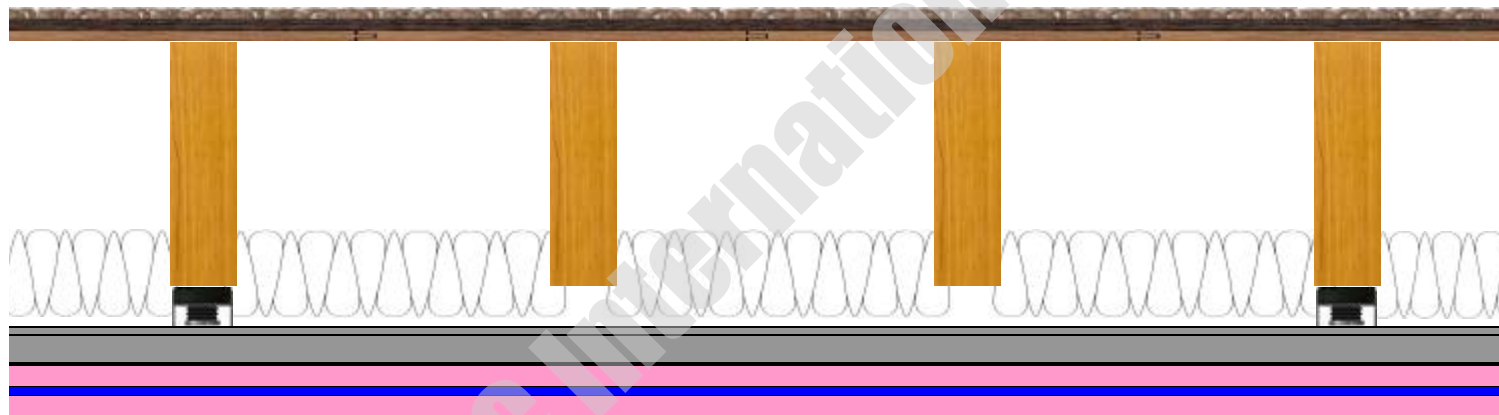

#### Construction

- \* Carpet - 40oz/per.sq.yd.
- \* Felt underlay - 36oz/per.sq.yd.
- \* 3/4" tongue and groove timber flooring.
- \* 2 x 10 timber joists at 16"oc.
- \* 3" fiberglass insulation between joists.
- \* RSIC-1 acoustic assembly screwed to joists at 4' 0"oc.
- \* 7/8" furring channels at 16"oc.
- \* 1 x 5/8" fire rated gypsum wallboard sheet.
- \* Audioseal Sound Barrier (AB10NR) - Acoustical Solutions Inc.
- \* 1 x 5/8" fire rated gypsum wallboard sheets taped and set.



SOUND TRANSMISSION CLASS	IMPACT ISOLATION CLASS
STC 60	IIC 82