

RSIC ACOUSTIC ASSEMBLY

NOISE CONTROL

FLOOR CEILING ASSEMBLY

DIRECT FIX TO CONCRETE



RSIC-V Shoot-In Adjustable Direct Concrete Mount

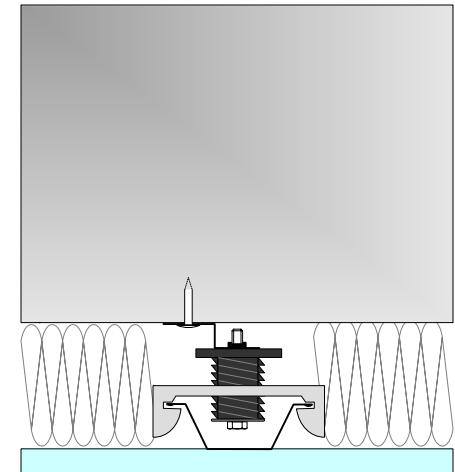
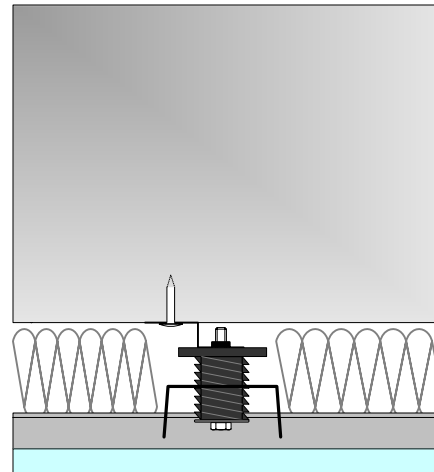
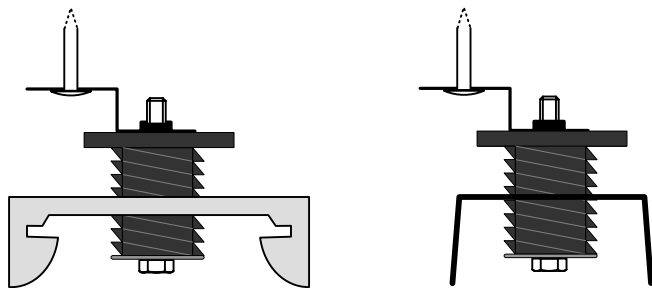

CONSTRUCTION

- 6"~10" CONCRETE PT SLAB
- ITW RAMSET 14TRHMP034 (1/4" THREAD)
- 1/4" x 20 FULL THREAD BOLT
- RSIC-SMART CLIPS AT 24" X 48" OC.
- (RSIC-SMART CLIP IS A LEVELING CLIP FOR UNEVEN CEILINGS)
- DRYWALL FURRING CHANNEL AT 24" OC.
- INSULATION (FILL CAVITY)
- 1 LAYER 5/8" FIRE-CODE GYP



NON COMBUSTIBLE

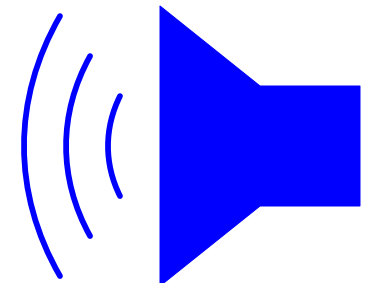

EST IIC 50 STC 65