

# RSIC-1 Acoustic Assembly

## FLOOR / CEILING SYSTEMS

### DIRECT FIX CEILING UNDER TIMBER FLOOR



**FCS 100-CJ Steel Joist**

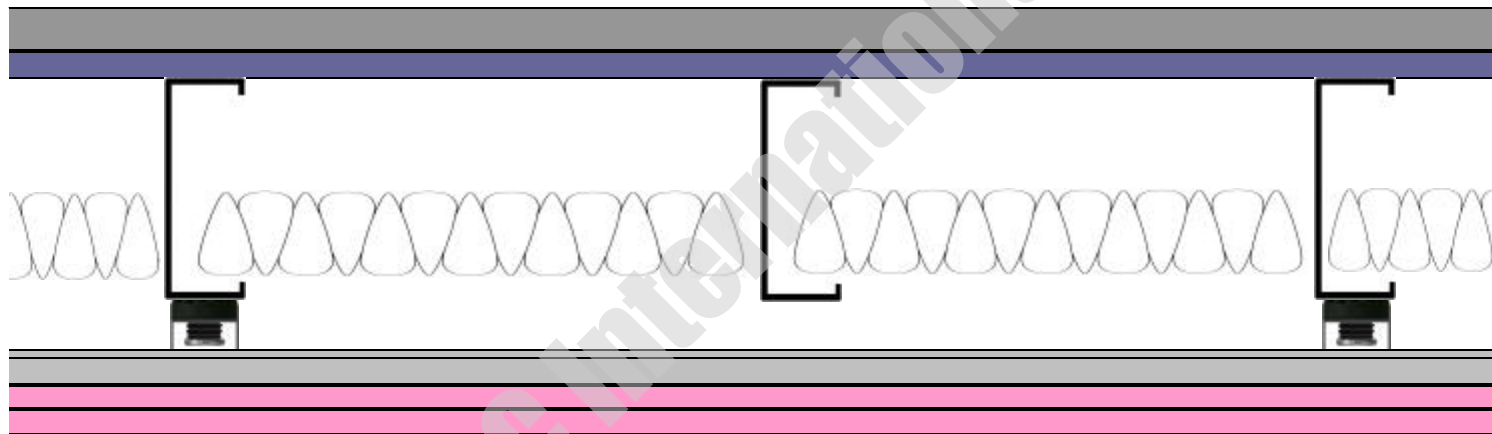

#### Construction

- \* 1 1/2" thick light weight 'Gypsum Cement' top coat..
- \* 3/4" tongue and groove 'USG Fiber Rock' substrate.
- \* 8 / 10" steel joists at 24"oc.
- \* 3 1/2" fiberglass insulation between joists.
- \* RSIC-1 acoustic assembly screwed to joists at 4' 0"oc.
- \* 7/8" furring channels at 2' 0"oc.
- \* 2 x 5/8" fire rated gypsum wallboard sheets taped and set.
- \* Opinion - 20310 RSA Acoustics ([www.rsaacoustics.com.au](http://www.rsaacoustics.com.au))

SOUND TRANSMISSION CLASS	IMPACT ISOLATION CLASS
STC 60	IIC 52