

RSIC-1 ACOUSTIC ASSEMBLY

FLOOR/CEILING ASSEMBLY



DIRECT FIX TO OPEN WEB FLOOR TRUSS

FCSITS-1 60-01

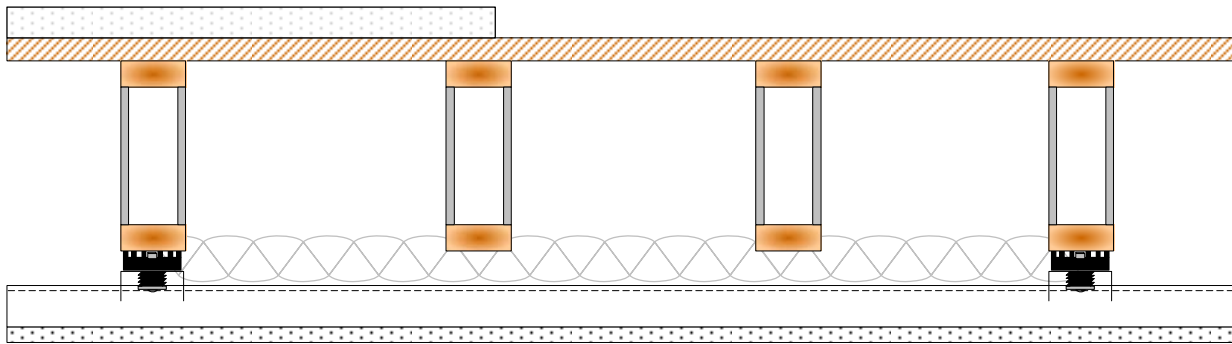

CONSTRUCTION

- * Topping
- * Min 5/8" Plywood or O-2 Waferboard
- * Structural Truswal SpaceJoist Metal Web
- * Optional Insulation
- * RSIC-1 installed 48" oc.
- * 7/8" furring channel 24" oc.
- * 1 Layer 5/8" Fire code "C" Gypsum Drywall

EST Insul 6.0



**FIELD SOUND
TRANSMISSION
CLASS**

STC 60



**1 HOUR
Design ITS TSC/FCA 60-01**

**FIELD IMPACT
ISOLATION
CLASS**

IIC 55

DESIGN NO. TSC/FCA 60-01
WITH SPACEJOIST METAL WEB, ASSEMBLY RATING: 60 MINUTES -
UNRESTRAINED; FLOOR/CEILING ASSEMBLY; FINISH RATING - 22 MINUTES

STC 50 with Insulation and Resilient Channels
STC 55 with 1-1/2" Lightweight Concrete

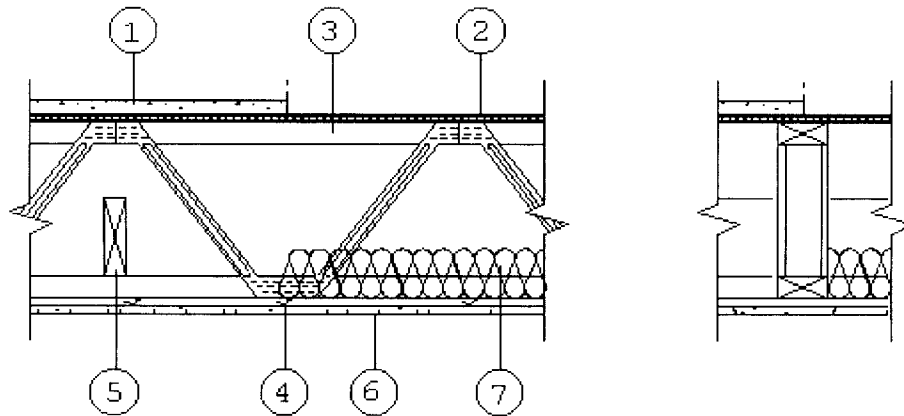

1. **Topping (Optional):** See General Information, Item 1.
2. **Flooring:** Minimum 5/8" (15.9mm) plywood or O-2 grade waferboard or strandboard (See General Information for spacing > 16" (400mm) oc.).
3. **Structural Member:** Truswal SpaceJoist metal web system with structural graded chords as per NLGA grading rules. All SpaceJoists are to be designed and sealed by a Professional Engineer.
4. **Furring Channels (Resilient Channel):** 1/2" deep with 24 gauge galvanized steel or 7/8" deep with 26 gauge galvanized steel. Unless otherwise noted, the maximum spacing of the channels is to be 24" oc, with the channels oriented perpendicular to joists and fastened directly to each joist with double strands of 18 gauge steel tie wire or screwed to each truss with 1-1/4" Type S drywall screws. Double rows of channels, spaced at least 3" apart are required at each gypsum wall board joint so that each board end rests on its own channel.
Steel Framing Members - (Optional, Not Shown) - Used as an alternate method to attach furring channels to trusses (Item 2). Clips spaced 48 in. OC. RSIC-1 clips secured to the bottom chord of alternating trusses with No. 8 x 2-1/2 in. coarse drywall screw through the center grommet. RSIC-V clips secured to the bottom chord of alternating trusses with No. 8 x 1-1/2 in. coarse drywall screw through the center hole. Furring channels are friction fitted into clips. Adjoining channels are overlapped as described in Item 3. As an alternate, ends of adjoining channels may be overlapped 6 in. and secured together with two min 7/16 in. long No. 6 self-tapping framing screws, at the midpoint of the overlap, with one screw on each flange of the channel. Additional clips required to hold furring channel that supports the gypsum board butt joints.
5. **Bridging/Strongback:** 2 x 6 SPF #2 to be screwed to the bottom chord with two 3" screws and spaced at 7' oc.
6. **Gypsum Board:** 4' x 10' x 5/8" Type C (listed Firecode C or Westroc Fireboard C) with edges running perpendicular to the furring channels. Screwed to channels with 1-1/4" Type S bugle head drywall screws set at 12" oc and 1-1/2" from edges of board (Minimum). All joints to be taped. Joints and screw heads covered with 2 layers of gyproc joint filler.
7. **Insulation (Optional):** See General Information, item 8.