

RC-1 Boost ACOUSTIC ASSEMBLY

FLOOR CEILING ASSEMBLY

DIRECT FIX TO SOLID WOOD JOIST

PAC International

World Leader in
Noise Control
Solutions



FC RC-1 Boost NGC 7013168

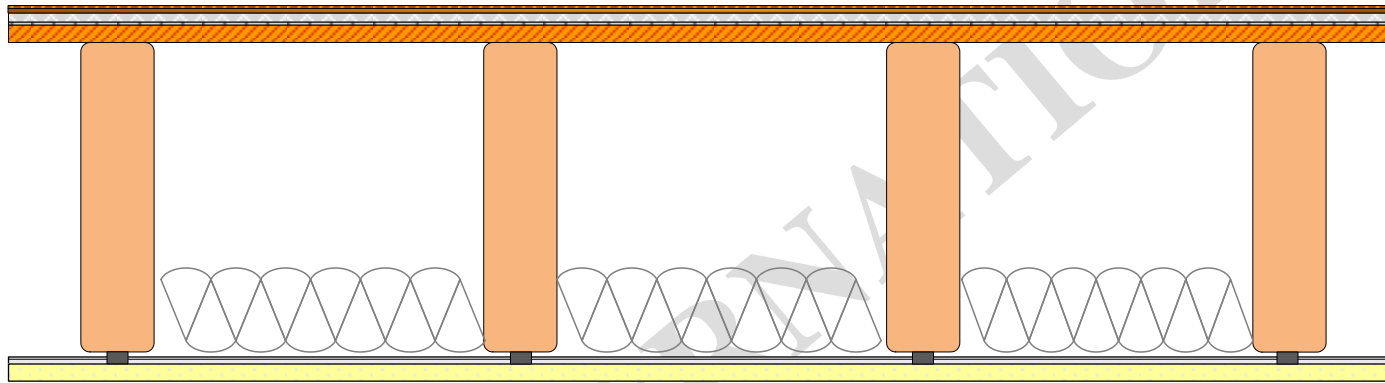

Fire Resistance Ratings

Designs:
M519, M537

Construction:

- Wood Laminate Flooring
- 1/2" Wood Underlayment
- 1" Hacker Firm-Fill Gypcrete
- 1 Layer Hacker SCM-250 Underlayment
- 5/8" T&G Plywood Subfloor
- 2" x 10" Solid Wood Joist @ 16" OC
- R-11 Fiberglass Batt Insulation (Nom 6")
- RC-1 Boost Installed @ 16" x 24" OC
- RC-Channel @ 24" OC
- 1 Layer 5/8" Pabco Flame Curb Type "C" Wallboard



STC 58

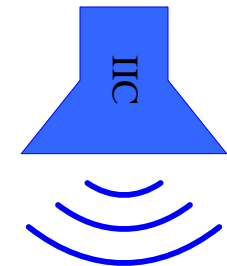

IIC 50